

Join us for a  
special evening  
celebrating and  
supporting the  
Eden Prairie  
Community

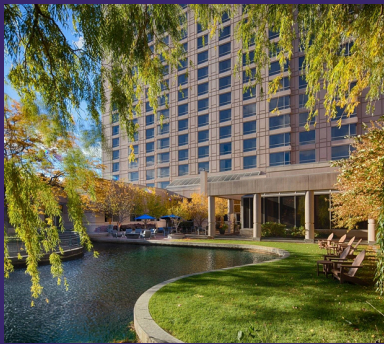

HERE FOR EDEN PRAIRIE.  
HERE FOR GOOD!



**Minneapolis  
Marriott  
Southwest**  
5801 Opus Pkwy  
Minnetonka, MN  
55343



**May 1, 2025  
5:30 p.m.**





## Join us on May 1 to celebrate and support our community!

For more than 40 years, the Eden Prairie Community Foundation has worked tirelessly to provide critical funding to make the city a welcoming and accessible community for everyone. The Foundation has awarded more than \$2 million in contributions for community support such as:

- Meals and produce for residents, including homebound seniors and individuals with disabilities.
- Food support for Eden Prairie families and schoolchildren.
- Scholarships for local youth.
- Emergency support and household goods for families living in poverty.
- Support for seniors and their caregivers.
- Services for homeless families, youth, and victims of domestic violence.
- Funding for Eden Prairie services, arts, parks, and recreational facilities.

EP Gives is an event that brings all of Eden Prairie together and is the Foundation's largest fundraiser. Every year, we gather to celebrate the quality of life our city brings to its residents, to learn about the needs of our neighbors, and to discover how we can help. Joining us will be city officials, community leaders, donors, and volunteers who are working to make Eden Prairie a better place for everyone.

EP Gives is a fun and exciting event which will feature a reception and silent auction, dinner and program highlighting the Foundation's work in the community, a live auction featuring exciting vacation packages and other amazing items, as well as a special giving opportunity.

The following pages outline the unique sponsorship opportunities available to support this great event. All proceeds will benefit Eden Prairie residents.

If you have any questions regarding this event or your sponsorship commitment, please contact me at [GregLeeper@epcommunityfoundation.org](mailto:GregLeeper@epcommunityfoundation.org) or call me at (952) 949-8499 and I'll be happy to help. We hope you will join us for this incredible night of fun and fundraising for the community!

A handwritten signature in purple ink, reading 'Greg Leeper'.

Greg Leeper, Executive Director  
Eden Prairie Community Foundation



# Sponsorship and Donation Opportunities

## Exclusive Presenting Sponsor - \$10,000 (\$8,460 tax deductible)

- Premium dinner seating for 20 guests (2 tables) and two beverage tickets for each guest.
- Name/logo recognition during the pre-show and event program.
- Name/logo placement on the event website, as well as all pre-event communications, listed as EP Gives, presented by (your logo).
- The opportunity to make brief welcoming remarks at the event.
- Two individualized social media posts recognizing your commitment to EP Gives.
- Logo recognition in the post-event e-blast, the EPCF newsletter, and the EPCF Annual Report.



## Gold Sponsor - \$5,000 (\$3,720 tax deductible)

- Dinner seating for 20 guests (2 tables) and one beverage ticket for each guest.
- Name/logo recognition during the pre-show and event program.
- Name/logo placement on the event website, as well as all pre-event communications.
- An individualized social media post recognizing your commitment to EP Gives.
- Logo recognition in the post-event e-blast, the EPCF newsletter, and the EPCF Annual Report.



## Silver Sponsor - \$3,000 (\$2,490 tax deductible)

- Dinner seating for 10 guests (1 table).
- Name recognition during the pre-show and event program.
- Name placement on the event website, as well as all pre-event communications.
- One social media post recognizing all Silver Sponsors.
- Name recognition in the post-event e-blast, the EPCF newsletter, and the EPCF Annual Report.

## Bronze Sponsor - \$1,500 (\$1,194 tax deductible)

- Dinner seating for 6 guests.
- Name recognition during the pre-show and event program.
- Name placement on the event website, as well as all pre-event communications.
- One social media post recognizing all Bronze Sponsors.
- Name recognition in the post-event e-blast, the EPCF newsletter, and the EPCF Annual Report.



## Additional Opportunities for Support

**Challenge Match** - \$500+ (100% tax deductible) - A donation of \$500 or more, which will be offered as part of a match during the giving opportunity at the event.

**Silent and Live Auction Items** – Consider donating an item for our silent and live auctions! For more information about donating items, please contact Tina Palmer at [tinapalmer@ecumen.org](mailto:tinapalmer@ecumen.org).



	Exclusive Presenting Sponsor \$10,000	Gold Sponsor \$5,000	Silver Sponsor \$3,000	Bronze Sponsor \$1,500	Challenge Match \$500+
Seating	2 tables (20 guests)	2 tables (20 guests)	1 table (10 guests)	6 seats	
Beverage tickets for guests	2 per guest	1 per guest			
Name/logo recognition in pre-show and event program	EP Gives, presented by (your logo)	Logo	Name	Name	Name
Name/logo placement on all pre-event communications	EP Gives, presented by (your logo)	Logo	Name	Name	
Opportunity to make brief welcoming remarks at the event	√				
Event website recognition	Logo/link	Logo/link	Name/link	Name	
Social media recognition	Two individualized social media posts unique to your organization.	One individualized social media post unique to your organization.	One social media post featuring all Silver Sponsors	One social media post featuring all Bronze Sponsors	One social media post featuring all challenge match donors
Recognition in post-event e-blast	√	√	√	√	
Recognition in the EPCF newsletter & Annual Report	Logo	Logo	Name	Name	
Sponsorship Tax Deductibility	\$8,460	\$3,720	\$2,490	\$1,194	100% tax deductible